



The Regeneration of the Regency Square Garden

From 2017, Brighton and Hove City Council has allocated some of the money it will receive from the i360 ticket sales each year, to improving and maintaining Regency Square gardens. The Council has asked the Regency Square Area Society to consult with local residents and businesses and draw up some proposals for how this money should be spent.

This is a great opportunity to say what we want the garden to look like and how we want to use it. Please take a few minutes to give us your views, and return this form by **FEBRUARY 28**.

1. What does the Regency Square garden mean to you?

.....
.....
.....
.....
.....
.....

2. How do you use the garden at present?

.....
.....
.....
.....
.....
.....

3. What changes would you like to see in the garden?

.....
.....
.....
.....
.....

4. How would you like to use the garden?

.....
.....
.....
.....
.....

5. How do you think the garden should look?

.....
.....
.....
.....
.....



6. Attached are three possible garden designs which have been drawn up for the square by well-known professional garden designer Diarmuid Gavin. Please rate them in order of preference, 1 being the one you most like and 3 your least preferred.

Searchlight ... Plumage ... Bumps ...

7. Below are some ideas for improvements and activities. Please tick all those which you would support.

- Replacing the current modern railings with period style railings
- Replacing the current modern street lamps with period style street lamps
(giving the same quality light)
- Replacing the current pavement slabs with the original Chailey Brick pavement
- Areas for picnics
- Exhibitions of art or sculpture
- Dog walking
- Educational projects with local schools
- The garden as part of the Biosphere (e.g. showing biodiversity or how beach
plants grow in sandy areas)
- Theatre or festival performances
- None of these – the gardens should be a peaceful area

8. Your ideas for changes, improvements and activities.

.....

.....

.....

.....

.....

.....

.....

.....

.....

.....

9. Please tell us about yourself (if you want to remain anonymous, that is ok too but we'd like to know what street/square you live on to make sure we represent the views of the whole area):

Name:

Address: (Street or Square).....

Email Address:

Telephone number:

Garden Design 1: Searchlight

"The square was originally developed to allow views from the houses to the sea.

With this option I'm following the notion of sight lines and taking inspiration from other ideas, some quite contemporary. So, from the sundial type shadow to be generated by the i360 through wartime searchlights and coastal lighthouses, the crisscross lines of Hyde Park pathways to abstract art." – Diarmuid Gavin

Searchlight: Plan

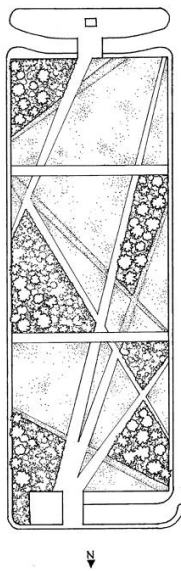

Searchlight: illustration

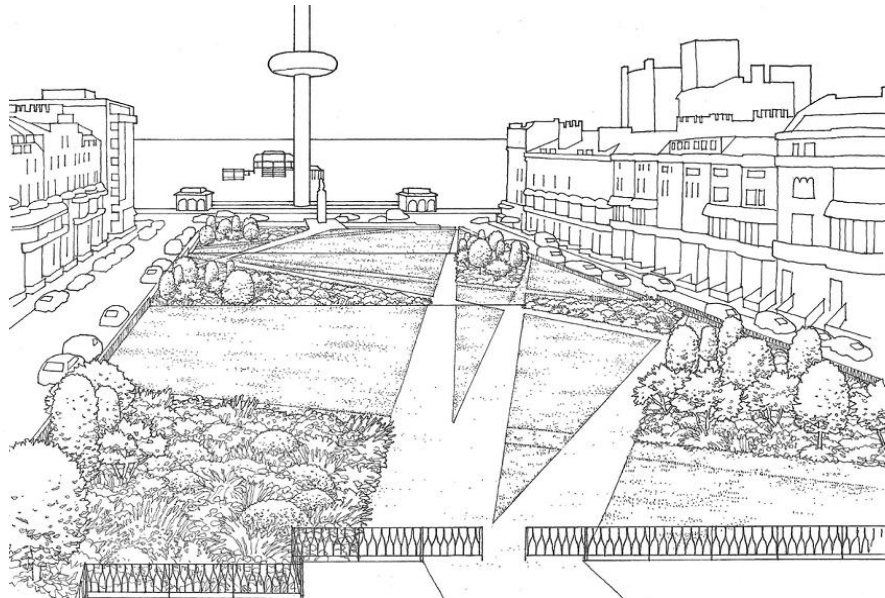

Garden Design 2: Plumage

"Seaside parks and gardens are famed for their use of flamboyant colour in exuberant flower beds. Considering that the gardens of Regency Square are often viewed from some elevation, whether presently in the surrounding townhouses or in the future through views from the i360 as it travels, I've embraced regal shapes to bathe the plot in seasonal colour." – Diarmuid Gavin

Plumage: Plan

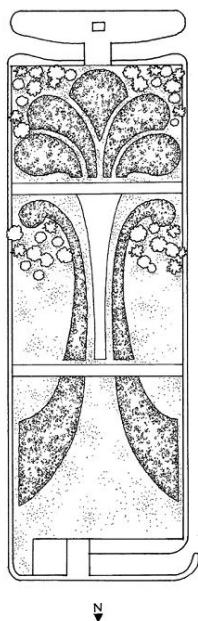

Plumage: illustration

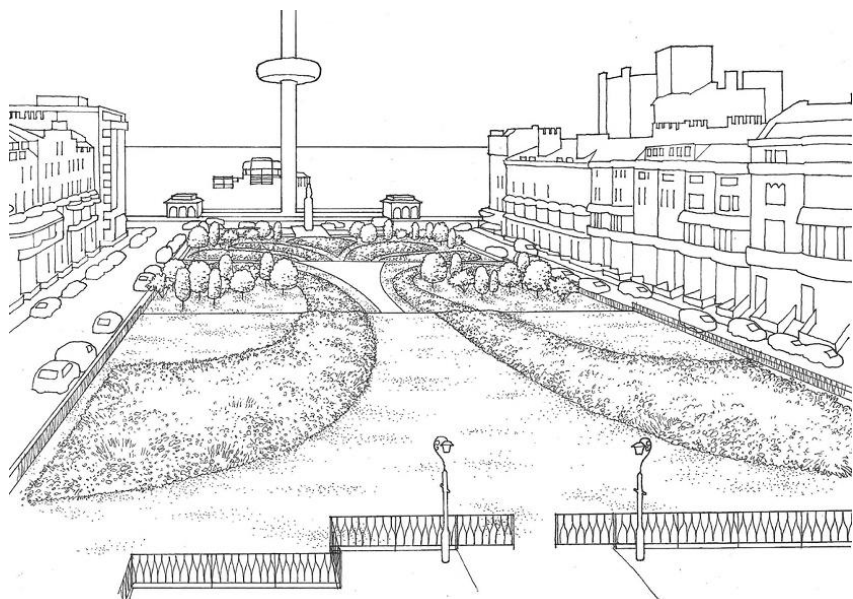

Garden Design 3: Bumps

“This notion is pure fun. It’s a simple concept created by using sculptural forms to make an abstract pattern.

Grass mounds or bumps are set out in concentric rings, each increasing in volume the further they travel from the centre. This is imagined as a scheme to create subtle sculptural and humorous interest from homes on the square, for passers-by and certainly from the i360. People love mounds....to gather around, to roll down, to run around.....to conquer.

They are designed to make the most of the sloping site and will appear to be bigger from a distance. Because of their round form, like domed jelly moulds, they won’t block views, rather, they should add to the increasingly playful vista.” – Diarmuid Gavin

Bumps: Plan

Bumps: illustration

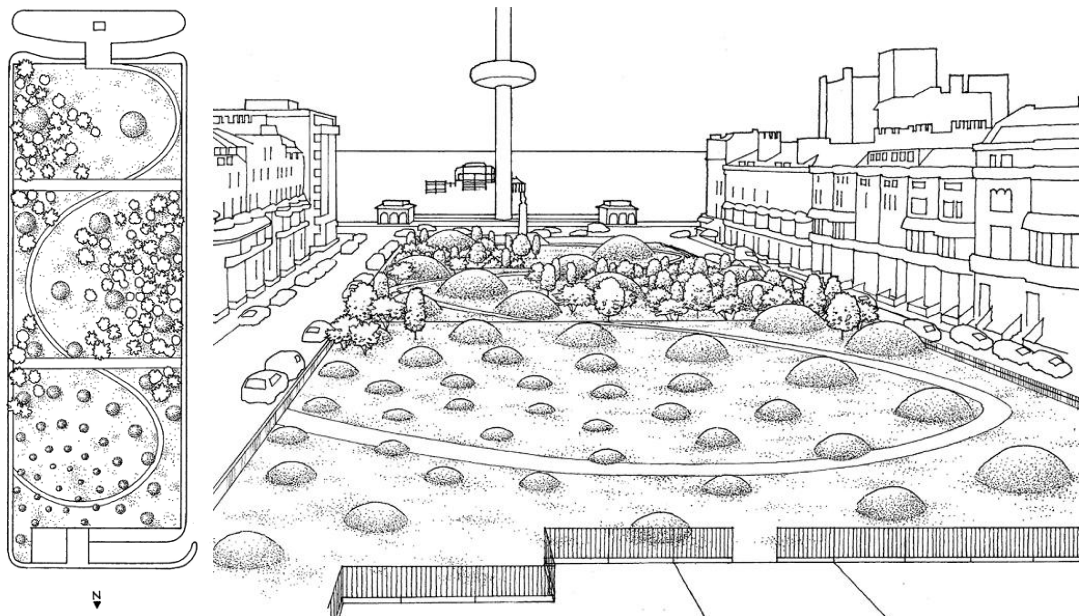

Please return your completed questionnaire to: Nigel Rose at 65/66 Regency Square, Brighton by FEBRUARY 28.

Alternatively, you can email your response to Nicola.Floyd@yahoo.com

If you would like to become a member of the Regency Square Area Society, and support the work that we do as well as receive our monthly newsletter covering everything that is going on in our local area, please contact our Treasurer Nicola Floyd at: Nicola.Floyd@yahoo.com or 07833 527270. Membership starts at just £5 for individuals and £8 for local businesses.